



PACK Series are the most versatile, self-contained and ductable systems on the market. Applications include wine cellars; art or document preservation; instrument or fur storage; niche environments, and more; these units can be used in nearly any application. Nominal cooling capacities from ¼-ton to 2-tons, available as air-cooled or water-cooled, these small units can meet a variety of needs.

All inclusive: High- and low-pressure safety switches, refrigerant access ports, standard integral electric heater, and all-weather low-ambient kit for winter operation

Convenient: Utility & piping in one easily accessible location; 80 to 200 lbs.

Versatile: Air-cooled or water-cooled configuration (geothermal or house-water, etc.)

Durable: Aluminum body and all aluminum evaporator coils are light weight and corrosion resistant; high static pressure fan (for extended lengths of ductwork)

Unique options: Remote user interface control system (for external monitoring of cellar/room conditions); bolt-on humidifier

Flexible: Multiple (3 sides) evaporator and condenser outlet locations for flexibility

Model	Total Cooling (BTUH)*		Heat (KW)	Voltage
	Wine Cellars (57F/55%)	ASHRAE (80F/50%)		
PACK25	3,540	4,425	1	115
PACK50	5,860	7,835	1	115
PACK88	8,760	11,300	2.0	230
PACK200	15,900	20,500	2.0	230

* See detailed specifications for complete product performance specifications, above table to be used as a guide only, based on 90F condenser inlet conditions and maximum evaporator airflow at 0.0" esp.



PACK Series images



Side view with panels removed



Wall-mount controls measure temperature and humidity

Options and Accessories



Shown with optional humidifier



Remote sensor allows for averaging multiple sensors or to remotely locate wall mount control

Illustrations

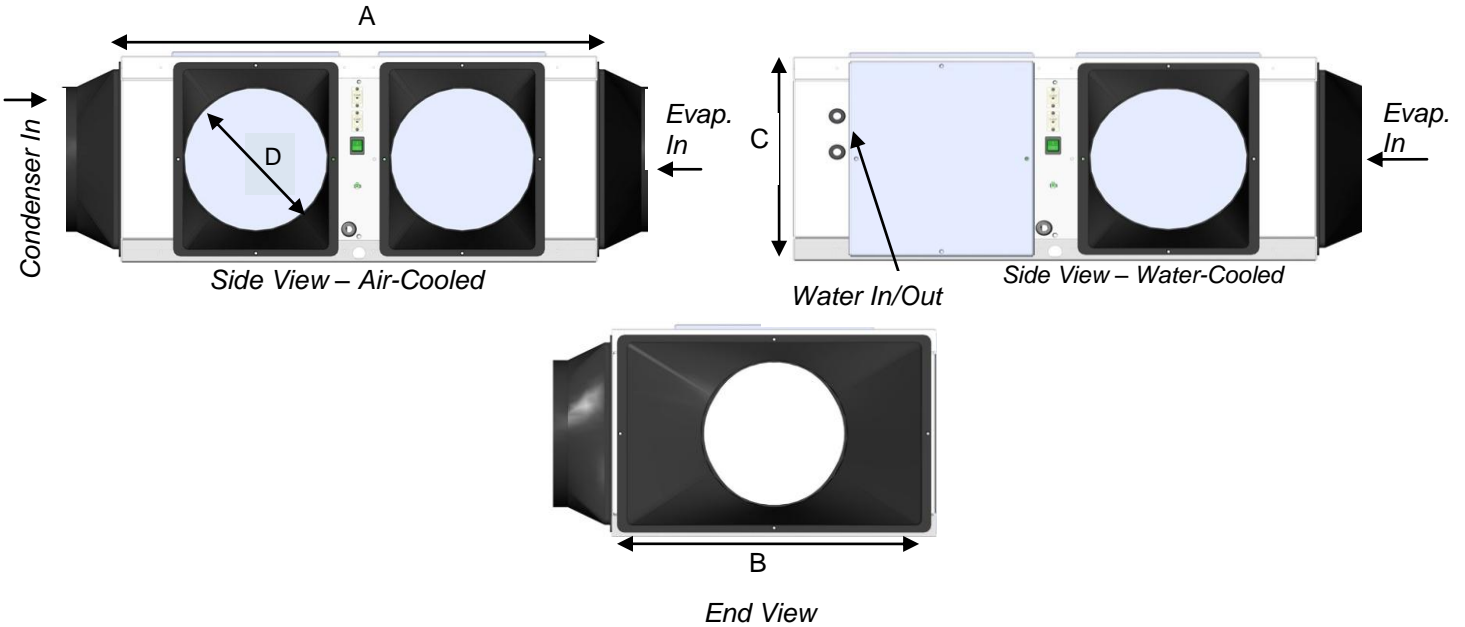

Specifications – Subject to change

Model	A	B	C	D	Weight
PACK25	33	14	14	8	80
PACK50	33	22	14	10	125
PACK88	33	22	14	10	130
PACK200	50	22	18	12	200

Note: (length, width, and height in inches; weight in pounds)



AIR INNOVATIONS®

7000 Performance Drive, North Syracuse, NY 13212, USA

800-535-3268

• 315-452-7400

• www.airinnovations.com

• info@airinnovations.com



SPECIFICATIONS

PACK Series

Self-Contained Ducted Systems

Model Number		PACK25	PACK50	PACK88		PACK200	
Power Requirements	volt/phase/hz	115/1/60	115/1/60	208/1/60	230/1/60	208/1/60	230/1/60
Performance (57°/55%RH)							
Nominal Compressor	HP	0.33	0.50	1	1	2.5	2.5
Net Cooling Capacity*		Total/Sensible	Total/Sensible	Total/Sensible	Total/Sensible	Total/Sensible	Total/Sensible
@60 Deg F condenser inlet air	BTUH	4520/3050	6920/4920	10700/7120	10830/7500	17570/12430	17680/12790
@70 Deg F condenser inlet air	BTUH	4300/2915	6570/4740	9900/6800	10250/7160	16580/11650	16720/12000
@80 Deg F condenser inlet air	BTUH	3760/2715	6320/4510	9420/6610	9600/6850	15350/11100	15680/11780
@90 Deg F condenser inlet air	BTUH	3540/2580	5860/4230	8600/6120	8760/6210	14000/10580	15000/10870
@110 Deg F condenser inlet air	BTUH	3260/2400	4865/3820	N/A	N/A	N/A	N/A
@120 Deg F condenser inlet air	BTUH	3000/2260	4585/3590	N/A	N/A	N/A	N/A
Performance (80°/50%RH)							
Nominal Compressor	HP	0.33	0.50	1	1	2.5	2.5
Net Cooling Capacity*		Total/Sensible	Total/Sensible	Total/Sensible	Total/Sensible	Total/Sensible	Total/Sensible
@60 Deg F condenser inlet air	BTUH	5980/4000	9830/6990	14330/9530	14560/10000	25450/18000	25600/18530
@70 Deg F condenser inlet air	BTUH	5570/3780	9250/6680	13690/9400	13860/9680	24250/17000	24460/17550
@80 Deg F condenser inlet air	BTUH	5080/3660	8720/6220	13000/9130	13140/9370	22440/16230	22930/17220
@90 Deg F condenser inlet air	BTUH	4425/3500	7835/5800	11800/8400	11300/8450	19500/15800	20500/15150
@110 Deg F condenser inlet air	BTUH	4070/3000	7140/5610	N/A	N/A	N/A	N/A
@120 Deg F condenser inlet air	BTUH	3780/2840	6690/5230	N/A	N/A	N/A	N/A
Controls							
Type		Room mounted non-programmable combination thermostat humidistat					
Temperature Accuracy/RH% Accuracy		+/- 1 Deg F / +/- 10% RH					
Evaporator Section							
Fan Motor Size	Watts	75	100	175	195	160	180
Rated Air Flow (free blow)	CFM	245	390	435	485	760	810
Rated Air Flow @ pressure loss	CFM	200 @0.10" wc	320 @0.20" wc	370 @0.20" wc	440 @0.20" wc	710 @0.35" wc	745 @0.35" wc
Air-cooled Condenser Section							
Fan Motor Size	Watts	75	100	175	195	160	180
Rated Air Flow (free blow)	CFM	245	390	435	485	760	810
Rated Air Flow @ pressure loss	CFM	200 @0.10" wc	320 @0.20" wc	370 @0.20" wc	440 @0.20" wc	700 @0.35" wc	725 @0.35" wc
Water-cooled Condenser Section (option)							
Water usage at 40 Deg F rise	GMP	0.30	0.60	1.20		2.50	
Pressure drop	PSI	0.40	0.40	0.08		1.20	
Pipe connection size (in/out) O.D.	Inches	0.63	0.63	0.63		0.63	
Heat							
Type		Electric	Electric	Electric	Electric	Electric	Electric
Capacity	Watt/BTUH	1000/3400	1000/3400	1635/5582	2000/6800	1635/5582	2000/6800
Humidifier (Option)							
Type		Removable drip pad with integral fan					
Capacity - water temp of 60 Deg F	lbs./hr	0.42					
Capacity - water temp of 90 Deg F	lbs./hr	0.97					
Capacity - water temp of 100 Deg F	lbs./hr	1.11					
Electrical Requirements							
Current Draw - Cooling mode	Amps	7.1	11.3	9.8	8.8	15.6	14.1
Current Draw - Heating mode	Amps	9.4	9.6	8.8	9.5	8.8	9.5
Minimum Circuit amps (heat / no heat)	Amps	11.6/8.6	11.8/13.7	10.7/11.8	11.7/10.6	10.7/19.1	11.7/17.2
Optional Low Ambient	Amps	0.4	0.4	0.2	0.2	0.2	0.2
Optional High Ambient	Amps	0.2	0	N/A	N/A	N/A	N/A
Optional Humidifier	Amps	0.4	0.4	0.4	0.4	0.4	0.4
Cabinet							
Construction		Aluminum					
Finish		Clear Anodized Brushed Aluminum					
Weight	lbs.	80	125	130		200	
Dimensions (inches)	Width	33	33	33		50	
	Depth	14	22	22		22	
	Height	14	14	14		18	
Condensate Drain connection (ID)							
	inches	.50"	.50"	.50"		.50"	
Agency Approval(s)							
	ETL	UL 1995/CSA C22.2	UL 1995 / CSA C22.2	UL 1995 / CSA C22.2		UL 1995 / CSA C22.2	

1. Reduce capacity by 3% for each 10% reduction in evaporator airflow.
2. Air Innovations reserves the right to make changes to this document without prior notice at its sole discretion.
3. All rating at sea level.
4. D200 air flow based on 0.35 inches Wine Guardian external static pressure using 50' of flexible ductwork, grills and collars.



SPLIT Series are the most versatile, ductable, split systems on the market. Applications include wine cellars; art or document preservation; instrument or fur storage; niche environments, and more; these units can be used in nearly any application. Any of the 5 sides (straight through, either side, top or bottom) can be used for outlet air. Nominal cooling capacities range from ¼ ton to 2 tons.

All inclusive: High- and low-pressure safety switches, refrigerant sight glass and access ports, integral electric heater, and standard all-weather housing and low-ambient controls on condensing unit for winter operation.

Convenient: Utility & piping in one easily accessible location

Light Weight: Evaporator 25-56 lbs.

Durable: Aluminum body and all aluminum evaporator coils are corrosion resistant; standard high-static pressure fan (for extended lengths of ductwork)

Flexible: Multiple evaporator outlet locations (any one of 5), mountable between joists

Unique options: Remote user interface control system (for external monitoring of cellar/room conditions); bolt-on humidifier

Model	Total Cooling (BTUH)*		Heat (kW)	Voltage
	Wine Cellars (57F/55%)	ASHRAE (80F/50%)		
SPLIT25	3,830	4,180	1	115
SPLIT50	5,500	7,760	1	115
SPLIT88	9,420	10,690	2.0	230
SPLIT200	14,900	20,100	2.0	230

* See detailed specifications for complete product performance specifications, above table to be used as a guide only, based on 90F condenser inlet conditions and maximum evaporator airflow at 0.0" esp.

SPLIT Series Images



End view with panels removed



Wall-mount controls measure temperature and humidity

Options and Accessories

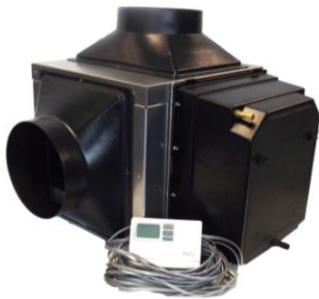

Shown with optional humidifier



Remote sensor allows for wall-mount control panel placement outside temp-controlled room

Illustration – Side View

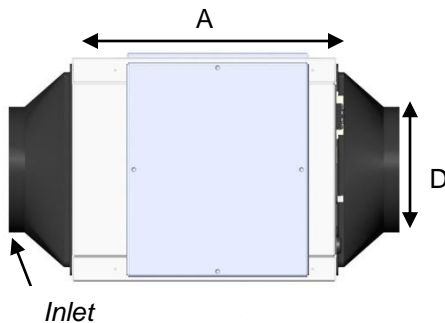
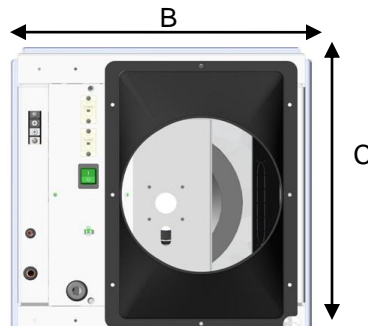
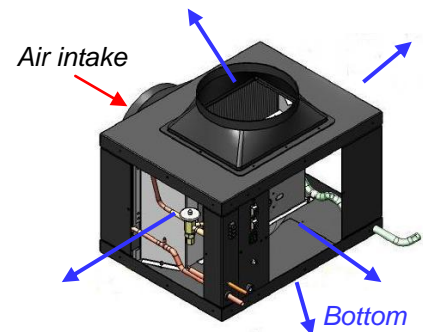

Illustration – End View



**** Special collar needed for 1/4-ton when using the above application**

Illustration – Airflow



5 options for evaporator supply air locations
(Cool air to wine cellar)

Specifications – Subject to change

Model	A	B	C	D	Weight	Outdoor Condenser			
						Length	Width	Height	Weight
SPLIT25	16.75	14.00	14.13	8.00	25	24.13	19.13	18.25	85
SPLIT50	16.75	22.00	14.13	10.00	35	24.13	19.13	18.25	98
SPLIT88	16.75	22.00	14.13	10.00	37	30.25	23.38	22.25	152
SPLIT200	21.00	22.00	18.00	12.00	56	32.0	38.00	27.00	250

Note: (Length, width, and height in inches; weight in pounds)



AIR INNOVATIONS®

7000 Performance Drive, North Syracuse, NY 13212, USA

800-535-3268 • 315-452-7400 • www.arinnovations.com • info@airinnovations.com



SPECIFICATIONS SPLIT Series

Model Number		SPLIT25	SPLIT50	SPLIT88		SPLIT200	
Power Requirements	volt/phase/hz	@ 115V	@ 115V	@208V	@230V	@208V	@230V
Performance (57°/55%RH)							
Net Cooling Capacity*		Total/Sensible	Total/Sensible	Total/Sensible	Total/Sensible	Total/Sensible	Total/Sensible
@10 Deg F condenser inlet air	BTUH	3120/2150	4380/3240	9965/6965	10270/7180	11,340/8200	11,750/8400
@40 Deg F condenser inlet air	BTUH	3150/2280	5370/3890	10310/7080	10630/7300	11,400/8350	11,800/9300
@60 Deg F condenser inlet air	BTUH	4140/3000	5770/4170	10440/7400	10760/7630	15,150/11,100	15,700/12,100
@80 Deg F condenser inlet air	BTUH	3830/2870	5500/4250	9140/6920	9420/7135	14,400/10,550	14,900/11,400
@100 Deg F condenser inlet air	BTUH	3400/2735	4650/3630	7680/5695	7920/5870	13,800/10,100	14,300/11,100
@115 Deg F condenser inlet air	BTUH	3110/2525	4640/3360	6985/5085	7200/5240	12,400/9100	12,800/10,100
Performance (80°/50%RH)							
Net Cooling Capacity*		Total/Sensible	Total/Sensible	Total/Sensible	Total/Sensible	Total/Sensible	Total/Sensible
@40 Deg F condenser inlet air	BTUH	6000/4850	10,500/7990	15,400/11,290	15,740/11,600	24,000/17,130	24,420/17,670
@60 Deg F condenser inlet air	BTUH	5840/5200	9600/7590	14,120/10,530	14,320/11,190	23,640/16,620	24,120/17,230
@80 Deg F condenser inlet air	BTUH	5060/4480	8570/7150	12,185/10,160	12,320/10,280	21,820/16,100	22,200/16,630
@100 Deg F condenser inlet air	BTUH	4500/4200	7800/6800	11,600/9700	11,700/9900	20,300/15,700	20,600/16,000
@115 Deg F condenser inlet air	BTUH	4100/4000	7000/6400	10,100/8800	10,300/9500	18,800/15,100	18,100/15,400
Controls							
Type		Room mounted non-programmable combination thermostat humidistat					
Temperature Accuracy/RH% Accuracy		+/- 1 Deg F / +/- 10% RH					

Fan Motor Size	Rated Watts	75	100	115	195	160	180
Rated Air Flow (free blow)	CFM	245	410	460	520	740	800
Rated Air Flow @ pressure loss	CFM	220 @0.10" wc	380 @0.20" wc	410 @0.20" wc	410 @0.20" wc	710@0.35"wc	750@0.35"wc
Heat							
Type		electric	electric	electric	electric	electric	electric
Capacity	Watt/BTUH	1000/3400	1000/3400	1635/5582	2000/6800	1635/5582	2000/6800
Humidifier (Option)							
Type		Removable drip pad with integral fan					
Capacity - water temp of 60 Deg F	lbs./hr	0.42					
Capacity - water temp of 90 Deg F	lbs./hr	0.97					
Capacity - water temp of 120 Deg F	lbs./hr	1.11					
Electrical Requirements							
Power	volt/phase/hz	115/1/60	115/1/60	208/1/60	230/1/60	208/1/60	230/1/60
Current Draw - Cooling mode	Amps	0.7	0.9	0.85	0.8	0.8	0.8
Current Draw - Heating mode	Amps	9.4	9.6	8.7	9.5	8.7	9.5
Minimum Circuit Size (w/heater option)	Amps	11.6	11.8	10.7	11.7	10.7	11.7
Optional Humidifier	Amps	0.3	0.3	0.2	0.2	0.2	0.2
Cabinet							
Construction		Aluminum					
Finish		Clear Anodized Brushed Aluminum					
Weight	lbs.	25	35	37		56	
Dimensions - inches	Length	16.75	16.75	16.75		21.00	
	Width	14.00	22.00	22.00		22.00	
	Height	14.13	14.13	14.13		18.00	
Condensate Drain - 1/2" id tubing	Inches	0.5	0.5	0.5		0.5	

Condensing Unit		M2FH-0039-IAA-0H2	M2FH-A056-IAA-0H2	FTAH-A101-CFV-0H2	FFAS-A25Z		
Nominal Compressor	HP	1/3 hp	1/2 hp	1 hp	2.5 hp		
Fan Motor Size	Watts	140	140	130	250		
Rated Air Flow (free blow)	CFM	450	450	710	1700		
Weight	lbs.	85	98	152	250		
Enclosure							
Construction		Steel	Steel	Steel	Steel		
Finish		Paint	Paint	Paint	Paint		
Dimensions	Length	24.13	24.13	30.25	32		
	Width	19.13	19.13	23.38	38		
	Height	18.25	18.25	22.25	27		
Electrical Requirements							
Power	volt/phase/hz	115/1/60	115/1/60	208/1/60	230/1/60	208/1/60	230/1/60
MCA	Amps	10.7	15.5	14.8	14.8	19	19
Max brkr	Amps	15	20	20	20	30	30
Agency Approval(s)							
		ETLc	ETLc	ETLc	ETLc		

1. Reduce capacity by 3% for each 10% reduction in evaporator airflow.
2. Air Innovations reserves the right to make changes to this document without prior notice at its sole discretion.
3. All ratings at sea level.

7000 Performance Drive | North Syracuse, New York 13212 USA

800-825-3268 | 315-452-7420 | Fax 315-452-7420 | www.airinnovations.com | info@airinnovations.com

Rev. 11-2013



PACK AND SPLIT SERIES WARRANTY

GENERAL

Air Innovations warrants, to the original buyer, its goods and all parts thereof to be free from defects in material and workmanship for a period of two (2) years from the date of invoicing assuming **NORMAL USE AND SERVICE**.

LIABILITY

Wine Guardian liability shall be limited to the repair or replacement (at its option) of any part, which, at our sole discretion, is determined to be defective. The purchaser shall pay all transportation costs. Additionally, if a malfunction occurs within the first year from the date of invoice **Air Innovations** will reimburse the reasonable cost of labor required for the repair or replacement provided authorization is obtained from one of our authorized representatives prior to incurring any labor charges.

LIMITATIONS OF LIABILITY

THESE WARRANTIES ARE MADE IN LIEU OFF ALL OTHER WARRANTIES EXPRESSED OR IMPLIED, INCLUDING ANY IMPLIED WARRANTY OF MERCHANTABILITY OR FITNESS FOR A PARTICULAR PURPOSE AND IN LIEU OF ANY OTHER OBLIGATION OR LIABILITY, INCLUDING LIABILITY FOR ANY INCIDENTAL OR CONSEQUENTIAL DAMAGES. **Air Innovations** will not be responsible for any costs or liabilities whatsoever resulting from improper installation or service of its equipment. In the event that **Air Innovations** or its distributors are found liable for damage based on any defect or nonconformity in the products, their total liability for each defective product shall not exceed the purchase price of such defective products. No person or representative is authorized to change these warranties or assume any other obligations or liabilities for **Air Innovations** in connection with the sale of its systems.

INDEMNIFICATION

Purchaser agrees to indemnify, hold harmless and defend seller and its officers, directors, agents and employees from and against any and all claims, liabilities, costs and expenses arising out of or related to Purchaser's use of the goods, or in any way involving injury to person or property or accident occasioned by the goods sold by **Air Innovations** to Purchaser.

FOREIGN GOVERNMENT AND INDIAN NATIONS

If Purchaser is a foreign government or an Indian nation, Purchaser hereby expressly waives its defense of sovereign immunity in the event of a dispute between Purchaser and **Air Innovations** regarding this invoice and Purchaser expressly acquiesces to the jurisdiction of the federal and state courts of the United States.

SEVERABILITY

If one or more of the provisions contained in this contract shall for any reason be held to be invalid, illegal or unenforceable in any respect, such invalidity, illegality or unenforceability shall not affect any provision of this contract, but this contract shall be construed as if such invalid, illegal or unenforceable provision had never been contained.

ADDITIONAL REQUIREMENTS

If a defect covered by the Warranty occurs, contact **Air Innovations** for authorization to proceed with corrective action. Do not return any parts or incur any charges for which you expect to be reimbursed under this Warranty without receiving this authorization. If parts are replaced under this Warranty, the defective parts must be returned prepaid within 30 days. This warranty shall be null and void in its entirety if the Serial Number on the air conditioner or compressor is altered, removed or defaced.



7000 Performance Drive | North Syracuse, NY 13212

315-452-7400 | 800-825-3268 | info@airinnovations.com | www.airinnovations.com



PACK AND SPLIT SERIES EXTENDED WARRANTY

Air Innovations shall provide a three (3) year extended warranty (5 years total) on the PACK and SPLIT SERIES compressors ONLY. Warranty covers the cost of a new replacement compressor should the “born with” PACK and SPLIT SERIES compressor be deemed defective anytime during the three (3) year extension. Warranty covers the cost of a new compressor, which must be supplied by Air Innovations. All shipping and labor charges for replacement of the new compressor are not covered under this extended warranty.

The PACK and SPLIT SERIES “born with” compressor must be returned to Air Innovations as proof of compressor replacement. Effective date for any extended warranty is the original invoice date for the PACK and SPLIT SERIES unit, not the purchase date of the extended warranty.



7000 Performance Drive | North Syracuse, NY 13212

315-452-7400 | 800-825-3268 | info@airinnovations.com | www.airinnovations.com